

PED explained



It is a contagious disease caused by a virus that attacks the pigs digestive system. This disease can affect pigs of all ages, but the mortality rate is higher in suckling piglets.

In this case, the mortality rate can reach 100%.

Affected animals may exhibit different symptoms, depending on their age:

- Excessive diarrhea
- Soft stools
- Vomiting
- Loss of appetite

The disease can be spread when healthy pigs come in contact with infected pigs.

The transmission can also take place indirectly:



- When in contact with vehicles which transported infected animals
- When in contact with contaminated surfaces or materials, including food
- Contaminated clothing and shoes worn by visitors or onsite workers can also contribute to spreading the virus

BIOSECURITY

Effective biosecurity is the key to stopping the spread of this disease, such as the introduction of animals from healthy herds, ensure that the trucks and equipment are clean and free from contamination.



THE WEST PENETONE BIOSECURITY PROGRAM

ADHERE CPM	CHLORINATED ALKALINE GEL CLEANER	Features & Benefits
	ADHERE CPM is a chlorinated liquid alkaline product especially designed to eliminate stubborn organic soil on premises and equipment in Hog Barns. Its unique feature is the ability to form a gel when dissolved in water. When ADHERE CPM is used as foam with appropriate equipment, the foam-gel solution clings to vertical surfaces for an almost unlimited period of time. ADHERE CPM will remove a wide range of soils, including those of animal and vegetable origin.	<ul style="list-style-type: none"> • Contains chlorine in the form of sodium hypochlorite • May be used in compressed air or manual foaming systems • Excellent adherence to vertical surfaces • Dilution rate: 2% to 5% • Available sizes: 4L, 20L, 205L, 1000L
GLUQUAT 2	HIGH-EFFICIENCY NEUTRAL DISINFECTANT	Features & Benefits
	GLUQUAT 2 is a non-corrosive, glutaraldehyde/quaternary ammonium-based disinfectant used for disinfection of agricultural and horticultural buildings such as hog barns and animal shelters, hatcheries, loading docks and livestock trucks and trailers. Gluquat 2's wide spectrum acts on most bacteria, viruses, mould and yeast. Effective against PED virus in 10 minutes, at 0.4%.	<ul style="list-style-type: none"> • Non corrosive • Contains 7.5% glutaraldehyde • Contains 20% 5th generation quaternary ammonium compounds • Effective in warm, cold and hard water • Long term residual effect • Pleasant odor during application • Available sizes: 4L, 20L, 205L, 1000L

CLEANING AND DISINFECTION PROCEDURES

1. Remove as much bedding and gross soils as possible with a rake or shovel (Avoid splashing to limit the spread of pathogens).
2. Rinse surfaces with clean water.
3. Apply an alkaline detergent with a foam gun at a dilution rate of 2% (Yellow Green tip) on all the surfaces.
4. Allow to dwell 5 to 25 minutes.
5. Stubborn soils in corners and contaminated areas should be scrubbed.
6. Rinse surfaces with clean water.
7. Visually inspect to ensure that no remaining matter or water accumulation remains on the surfaces (This could reduce the effectiveness of the disinfectant).
8. Adjust the disinfectant GLUQUAT 2 in your foamer gun to a concentration of 0.5% (Pink tip) to 0.8% (Dark Green tip) with a paper test strip QC-1001.
9. Apply the disinfectant GLUQUAT 2 to all the surfaces.
10. Let the solution dry.
11. Rinse all the water bowls before the arrival of the animals.



RECOMMENDED USE

- Walls
- Parks
- Floors
- Ceilings
- Hoppers
- Ventilation systems
- Water bowls
- Loading docks
- Gestation stalls
- Calving

EQUIPMENT

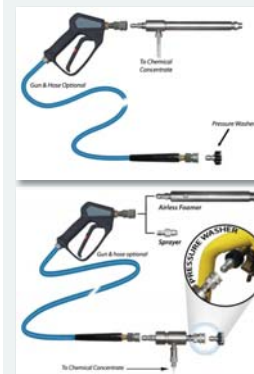

VALIDATION OF GLUQUAT 2 CONCENTRATION

1. Activate your foamer gun for 45 second while injecting the disinfectant.
2. Take a sample of the solution in a bucket.
3. Wait for the foam to dissipate (temperature between 65°F et 75°F).
4. Dip the test strip in the solution.
5. Compare your test strip result to the graduated scale.
6. Your result has to be equal or higher than 800 PPM.

It's important to make sure your foamer gun is well calibrated before the application of GLUQUAT 2.

METERING TIP COLOUR	CONCENTRATION
Pink	+/- 0,5 %
Dark Green	+/- 1 %
Yellow Green	+/- 2 %



PED VIRUS RESISTANCE TO COLD TEMPERATURES

A major feature of this virus is its resistance to low temperature, which increases its ease of transfer via vehicles or personnel; therefore increasing the difficulties of controlling its spread even in the context of the application of hygiene and biosecurity standards.

GLUQUAT 2 and WEST PROPYLENE GLYCOL is the perfect blend of chemicals to disinfect your loading docks or surfaces that may freeze in winter. This solution will increase your on-farm Biosecurity.

Prepare a 1 Litre solution of GLUQUAT 2 at the required concentration, according to temperature. Then add the required quantity of WEST PROPYLENE GLYCOL.

GLUQUAT 2 and WEST PROPYLENE GLYCOL Solution

GLUQUAT 2	For 1 Litre of water	WEST PROPYLENE GLYCOL	According to temperature	
			°C	°F
9 ml		112 ml	-3	26
10 ml		250 ml	-8	18
12 ml		429 ml	-14	7
14 ml		667 ml	-22	-8
16 ml		1000 ml	-34	-29
20 ml		1500 ml	-48	-55

Add clean bedding after applying the solution of disinfectant.

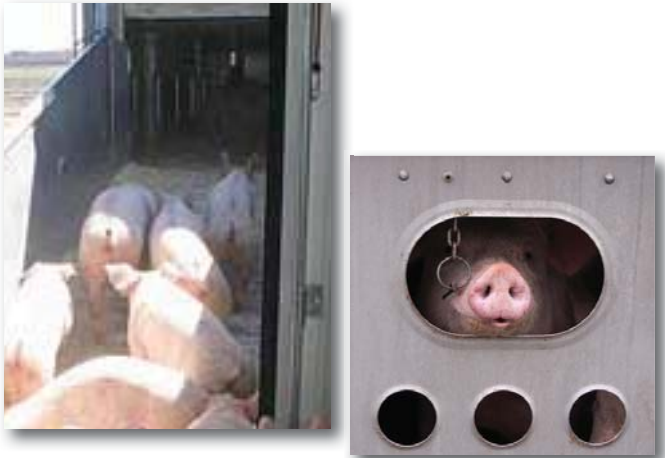

The Right Chemistry FOR HOG BARNs

The rigorous cleaning and maintenance needs of the agricultural industry demand specialized, highly effective products. At West Penetone, we've consistently met these demands with an innovative product line and a team of specialists who understand the rigorous requirements of the industry. And as the demand for more environmentally sound products has increased, West Penetone has delivered—with new breakthroughs in product performance and environmental and worker safety.

We back our commitment with some of the best customer service and support in the industry, including highly trained field representatives and on-site technical assistance.



MONTRÉAL
 10,900 rue Sécant
 Anjou, Québec H1J 1S5
 Tél.: 514-355-4660
 Sans frais : 1 800-361-8927

EDMONTON
 11411-160 Street
 Edmonton, Alberta T5M 3T7
 Tel.: 780-454-3919
 Toll free : 1 866-454-3919

www.westpenetone.com

West Penetone
Effective prevention of PED
 (Porcine Epidemic Diarrhea)



BIOSECURITY